

RoHS 2.0+HF

A

B

C

D

E

F

G

A

B

C

D

E

F

G

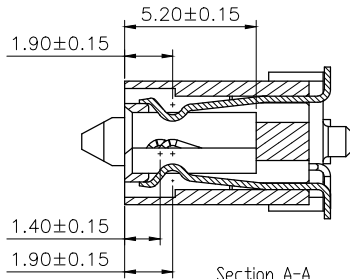
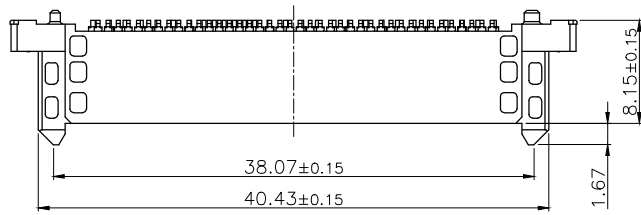

Section A-A
Scale 2:1

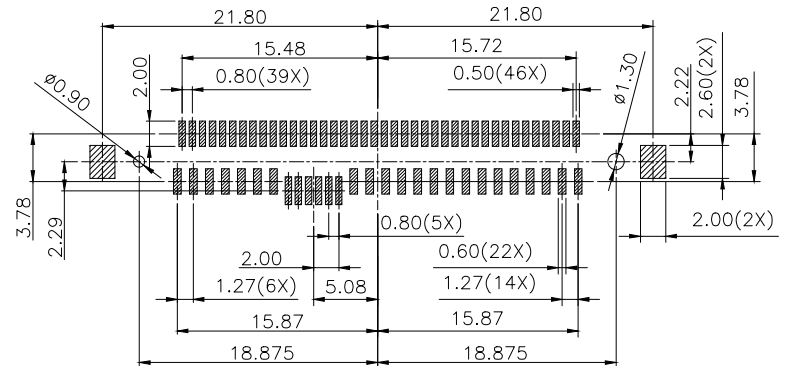

RECOMMENDED PCB LAYOUT
(GENERAL TOLERANCE:±0.05)

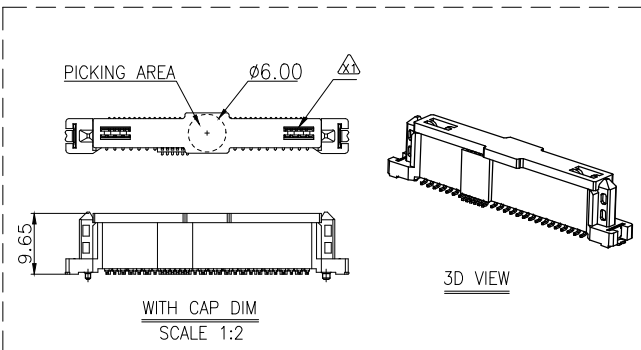
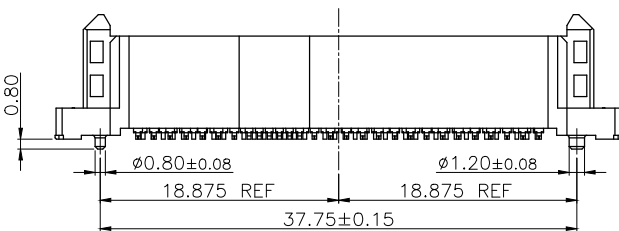
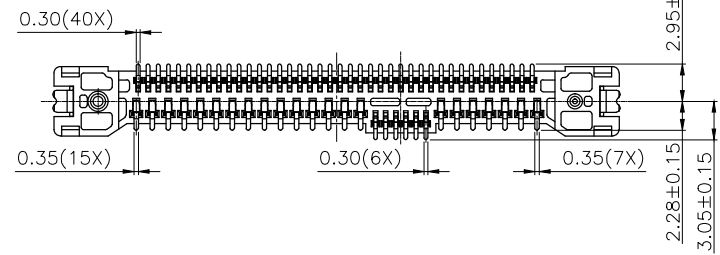
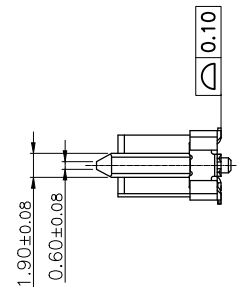
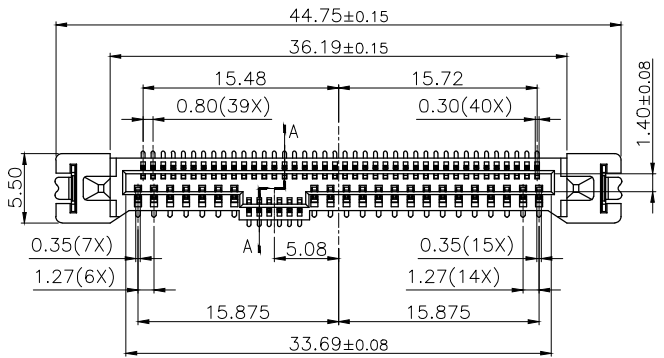

WITH CAP DIM
SCALE 1:2

- NOTES:
- MATERIAL:
HOUSING: HIGH TEMPERATURE THERMOPLASTIC UL 94V-0 LCP E130I,BLACK
CAP: HIGH TEMPERATURE THERMOPLASTIC UL 94V-0 LCP RE-GRINDING,BLACK
TERMINAL: COPPER ALLOY C5210,T=0.25MM
FORKLOCK: COPPER ALLOY C2680,T=0.30MM
 - FINISHED:
CONTACT: GOLD PLATING ONCONTACT AREA,MATTE TIN
PLATING ON SOLDER TAIL AREA,NICKEL UNDER
 - THE PRODUCT USING MATERIAL AND PROCESSING MUST CONFORM TO THE "WI-PZ-142"HSF TECHNICAL STANDARD CONTROL REQUIREMENTS
 - COPLANARITY: 0.10MM MAX

REV.	REVISION RECORD	DATE		GENERAL TOLERANCES		SCALE	NAME	DATE	PART NO.	DWG NO.				
AO	INITIAL RELEASED	2024.12.11		LINEAR	ANGLES	1:1								
				0.0±0.30	X° REF±5°	APPROVED								
			UNIT: MM	0.00±0.25	X° ±2°	DESIGNER	Jackie Tan	2024.12.10	TITLE					
			SIZE: A4	0.000±0.05	X° ±2°	DRAWN	Girder.Liang	2024.12.10	PCIE/SAS VERTICAL SMT REC-LONG LEGS+FORKLOCK SMT TYPE					

环保物料

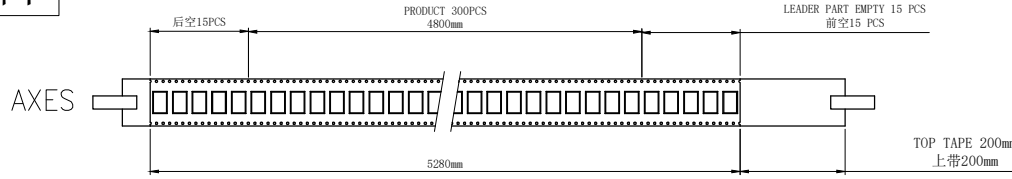

TAKING OUT DIRECTION

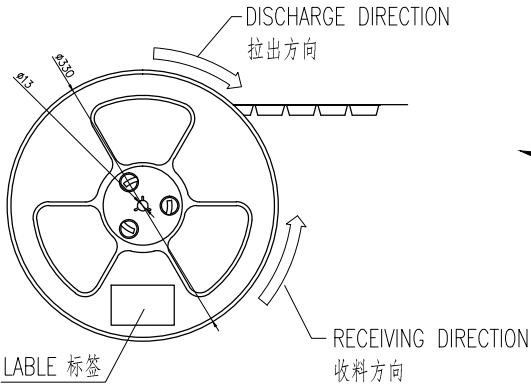
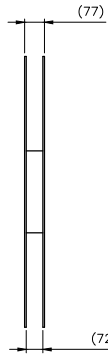

SINGLE HOLE: NONE HOLE SIDE
单孔: 贴无链孔侧

DOUBLE HOLE: ELLIPTICAL HOLE SIDE
双孔: 贴椭圆孔侧

COVER TAPE PEEL STRENGTH: 20~120g
上带剥离力量: 20~120g

速度 PEEL SPEED: 300mm/minute

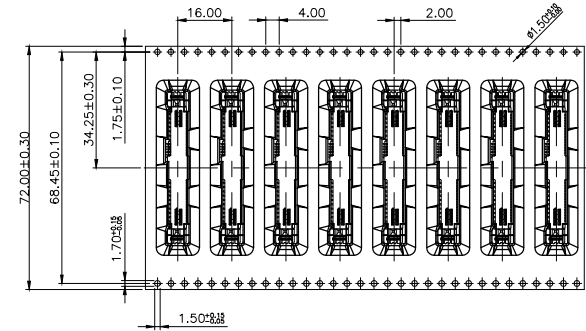
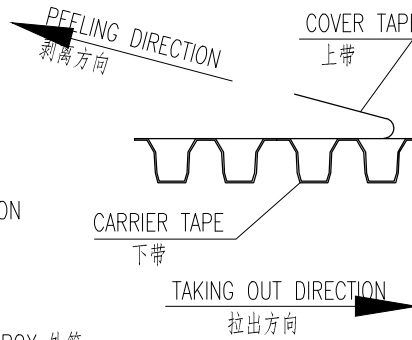

TAKING OUT DIRECTION

REEL/PCS	CARTON/R	CARTON/PCS
300	3	900

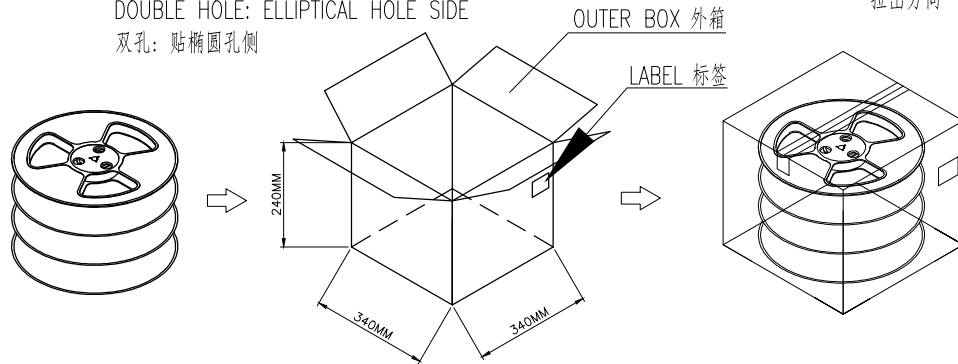

NOTE:

- CARRIER CAMBER IS WITHIN 1MM IN 100mm ; 带长100mm内容许弯曲度1mm;
- 10 SPROCKET HOLE PITCH CUMULATIVE TOLERANCE ±0.2mm; 圆孔十个孔距离累计允许公差为±0.2mm
- CARRIER TAPE MATERIAL FOR PS ; 下带材质为PS材质; COLOR颜色: BLACK黑色;
- BRACER保护带: COLOR颜色: NATURAL透明色; 厚度0.40mm最小;
- THICKNESS=0.50±0.05 ; 材料厚度为0.50±0.05mm;
- COVER TAPE上带: 冷风自粘带;

REV.	REVISION RECORD	DATE	UNIT: MM	GENERAL TOLERANCES		SCALE 1:1	NAME	DATE	PART NO.	DWG NO.	
A0	新图面发行	23.11.21		0.0±0.30	ANGLES X° REF±6°	APPROVED	Daniel Dong	2024.12.10	80802W00-2X68PA-SF-008	ENDE05	
			0.00±0.25	X° ±3°	DESIGNER	Jackie Tan	2024.12.10	TITLE			
			SIZE: A4	0.000±0.10	X° X° ±2°	DRAWN	Girder.Liang	2024.12.10	PCIE/SAS VERTICAL SMT REC-LONG LEGS+FORKLICK SMT TYPE		REV

1

2

3

4

5

6

7

8

REV A0 SHEET 1/1