

RoHS 2.0+HF

A

B

C

D

E

F

G

H

A

B

C

D

E

F

G

H

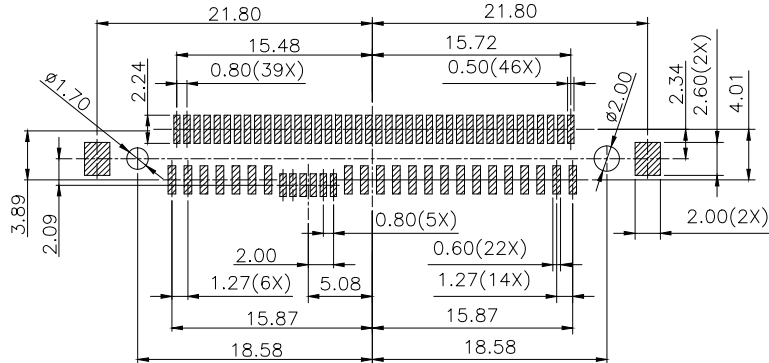
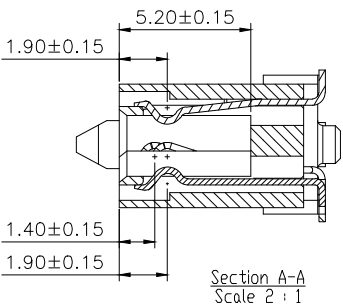
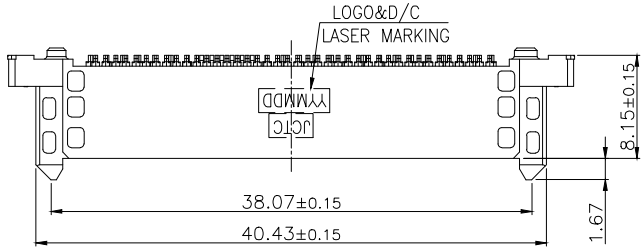

RECOMMENDED PCB LAYOUT
(GENERAL TOLERANCE: ±0.05)

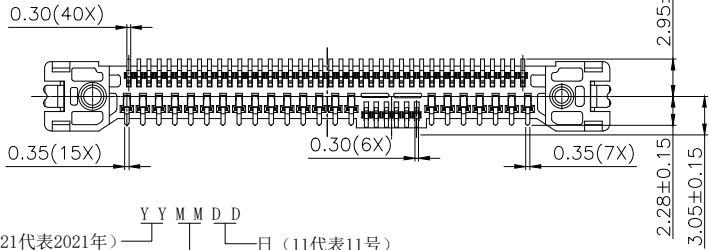
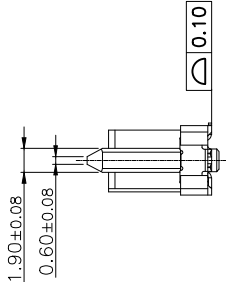
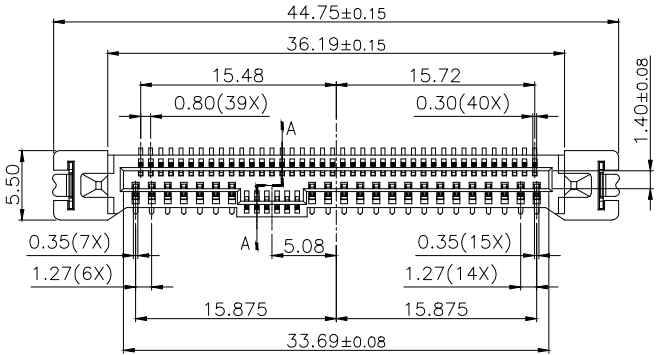

Y M M D D
年 (21代表2021年) 月 (09代表9月) 日 (11代表11号)

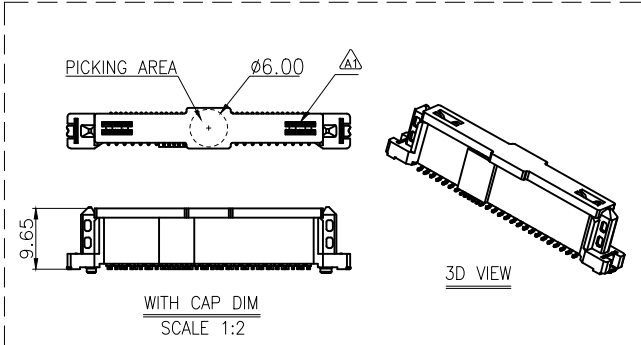
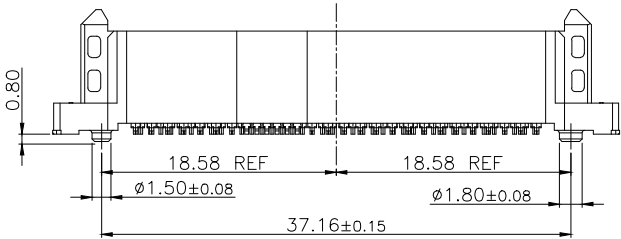

NOTES:
1.MATERIAL:
HOUSING: HIGH TEMPERATURE THERMOPLASTIC UL 94V-0 LCP E130I,BLACK
CAP: HIGH TEMPERATURE THERMOPLASTIC UL 94V-0 LCP RE-GRINDING,BLACK
TERMINAL: COPPER ALLOY C5210,T=0.25MM
FORKLOCK: COPPER ALLOY C2680,T=0.30MM
2.FINISHED:
CONTACT: GOLD PLATING ONCONTACT AREA,MATTE TIN PLATING ON SOLDER TAIL AREA,NICKEL UNDER
3.THE PRODUCT USING MATERIAL AND PROCESSING MUST CONFORM TO THE "WI-PZ-142 "HSF TECHNICAL STANDARD CONTROL REQUIREMENTS
4.COPLANARITY: 0.10MM MAX

REV.	REVISION RECORD	DATE		GENERAL TOLERANCES		SCALE	NAME	DATE	PART NO.	DWG NO.			
A0	INITIAL RELEASED	2022.07.11		LINEAR	ANGLES	1:1							
A1	CHANGE THE SHAPE OF THE SUCTION CAP	2022.9.23		0.0±0.30	X° REF±5°	APPROVED	Daniel Dong	2024.12.10	80802W00-2X68PA-SF-007	ENDE05			
A2	ADD THE SKIMMING HOLE	2024.12.10		0.00±0.25	X° ±2°	DESIGNER	Jackie Tan	2024.12.10	TITLE				
			0.000±0.05	X° ±2°	DRAWN	Girder.Liang	2024.12.10	PCIE/SAS VERTICAL SMT REC-LONG LEGS+FORKLOCK SMT TYPE					
			UNIT: MM							REV	A2	SHEET	1/1

1

2

3

4

5

6

7

8