

RECOMMENDED PCB LAYOUT  
GENERAL TOLERANCE ±0.05

NOTES:

Rated Voltage : 50V AC/DC  
Rated Current : 2A AC,DC  
Withstand Voltage : 500V AC/minute  
Contact Resistance : 40mΩ(MAX.)  
Insulation Resistance : 100MΩ(MIN.)  
Temperature Range : -25°C~+85°C

The product using material and processing must conform to the "WI-PZ-142"HSF technical standard control requirements

PART No:

**11202W90-NP-S-5F-W6**  
① ② ③ ④ ⑤ ⑥

- ① Series No.
- ② 90 : Side Contact
- ③ 00 : Up Contact
- ④ No. of Circuits
- ⑤ S: SMT TYPE
- ⑥ 5F: Au 10u"
- ⑥ W6: W6 Type

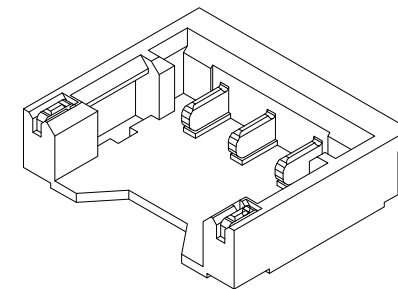

3D SHOWN

CKT	DIM A	DIM B	DIM C	DIM D
2	1.20	1.20	2.60	4.20
3	1.20	2.40	3.80	5.40
4	1.20	3.60	5.00	6.60
5	1.20	4.80	6.20	7.80
6	1.20	6.00	7.40	9.00

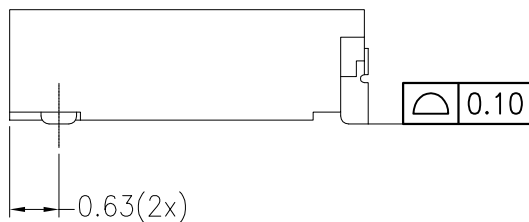
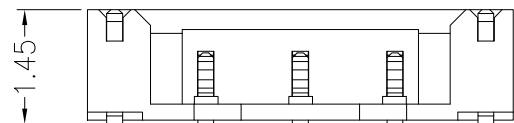

3	PEG	2	C2680	Ni 40u" UNDER PLATING OVER ALL, Sn PLATING OVER ALL
2	CONTACT	2~6	C2680	Ni 100u" UNDER PLATING OVER ALL, Au10u" PLATING OVER ALL
1	HOUSING	1	LCP	UL94V-0, BLACK
ITEM	PARTS	Q'TY	MATERIAL	REMARK

REV.	REVISION RECORD	DATE	GENERAL TOLERANCES		SCALE	NAME	DATE	PART NO.	DWG NO.	 <b>JCTC</b> <sup>®</sup> TERMINAL&CONNECTORS		
AO	The new version file were released	2021.11.02	LINEAR	ANGLES	1:1	Frey Yang	2021.11.02					
A1	新增PIN发行	2022.01.23	0.0±0.25	X° REF±6°	APPROVED	Daniel Dong	2021.11.02	11202W90-NP-S-5F-W6	ENDE05			
			0.00±0.20	X° ±3°	DESIGNER	Daniel Dong	2021.11.02				TITLE 1.2PH BTW CONN H1.45 RECEPTACLE	
			UNIT: MM	0.00±0.08	X° X' ±2°	DRAWN	Daniel Dong	2021.11.02	REV	A1		SHEET

